

EXISTING TOPOGRAPHY

EXISTING & PROPOSED TOPOGRAPHY

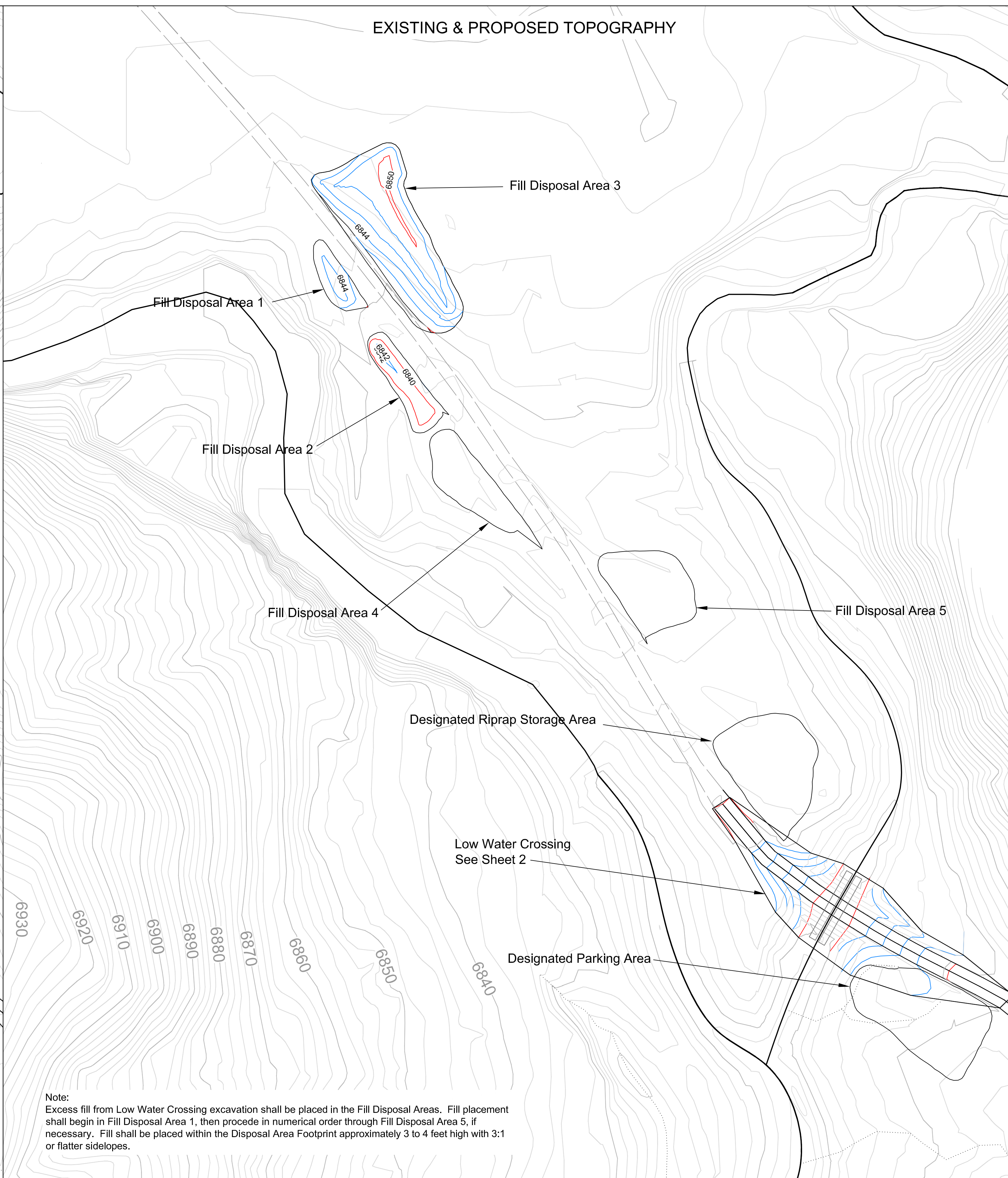
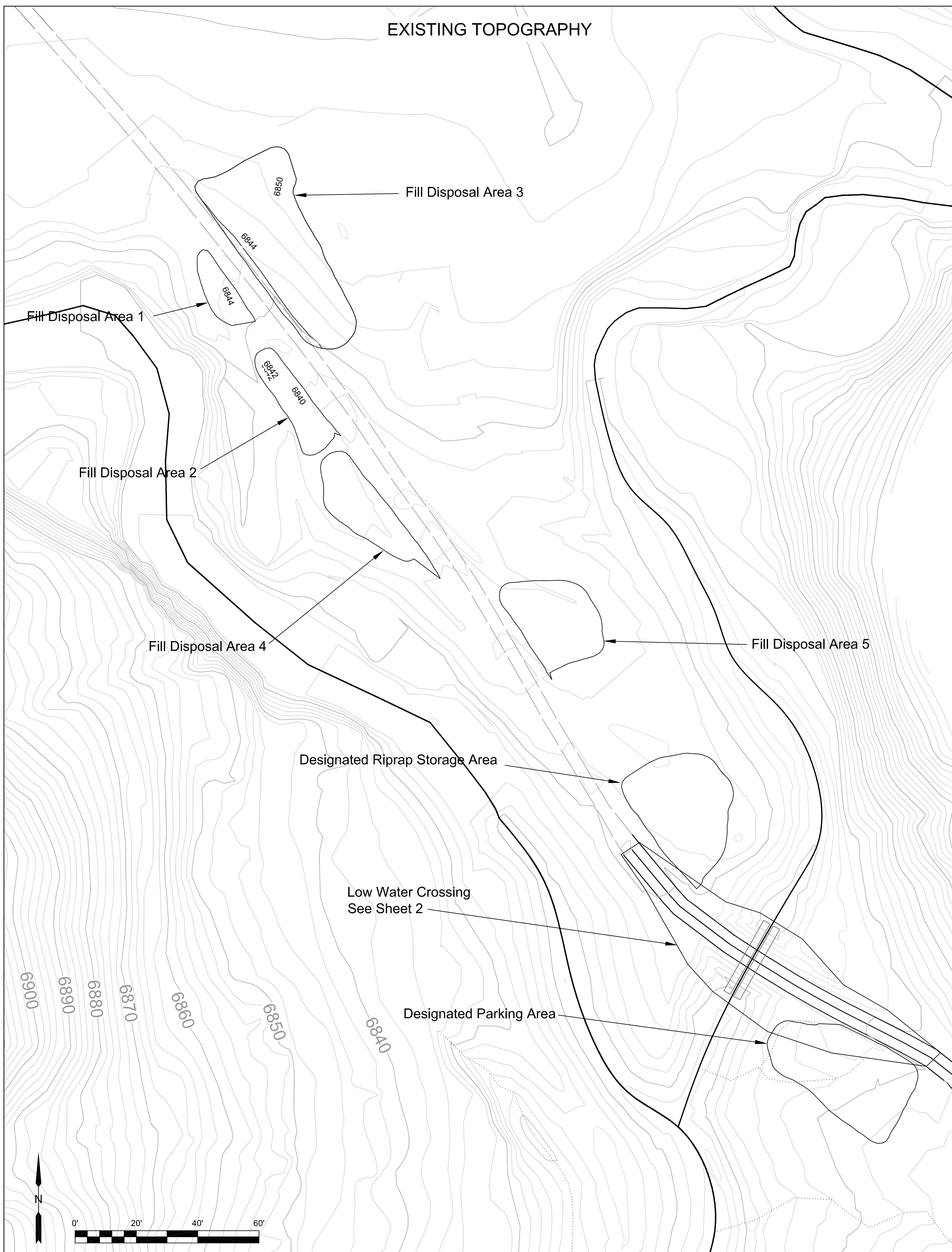

Note:
Excess fill from Low Water Crossing excavation shall be placed in the Fill Disposal Areas. Fill placement shall begin in Fill Disposal Area 1, then proceed in numerical order through Fill Disposal Area 5, if necessary. Fill shall be placed within the Disposal Area Footprint approximately 3 to 4 feet high with 3:1 or flatter sidelopes.

NO.	REVISIONS	BY	DATE

SCALE
CONTOUR INTERVAL: 2 FEET

LEGEND	
	Existing Index Contour (10' Interval)
	Existing Intermediate Contour (2' Interval)
	Design Index Contour (10' Interval)
	Design Intermediate Contour (2' Interval)
	New Road
	Constructed Channel
	Swale
	Power Pole
	Culvert

Water & Earth
TECHNOLOGIES

The horizontal coordinates are New Mexico State Plane Coordinates - East Zone, NAD 83 (HARN). The elevations are referred to sea level, NAVD 88.

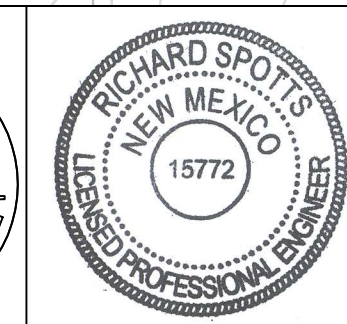
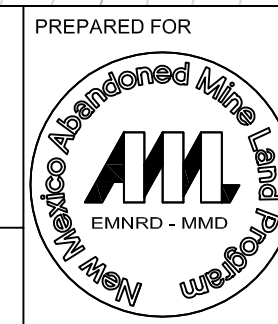

I hereby certify that the details shown on this sheet are correct to the best of my knowledge and belief.

TASK
SWASTIKA ROAD DESIGN
COAL CANYON LOW WATER CROSSING

TITLE
COAL CANYON LOW WATER CROSSING
PLAN VIEW

SHEET
2
OF
4